

Mulga Products®

(Australia)



Mulga Post 'N' Rail™ Fence

Installation Guide

- Step .1. Set out and mark the location of the posts holes at the following spacing, dependent upon the rail size
- | | |
|-------------|---------------------|
| FR2700 rail | (post 2.6m centres) |
| FR2500 rail | (post 2.4m centres) |
| FR2300 rail | (post 2.2m centres) |
| FR2100 rail | (post 2.0m centres) |
| FR1900 rail | (post 1.8m centres) |
| FR1700 rail | (post 1.6m centres) |
| FR1500 rail | (post 1.4m centres) |
| FR1050 rail | (post 950mm centre) |

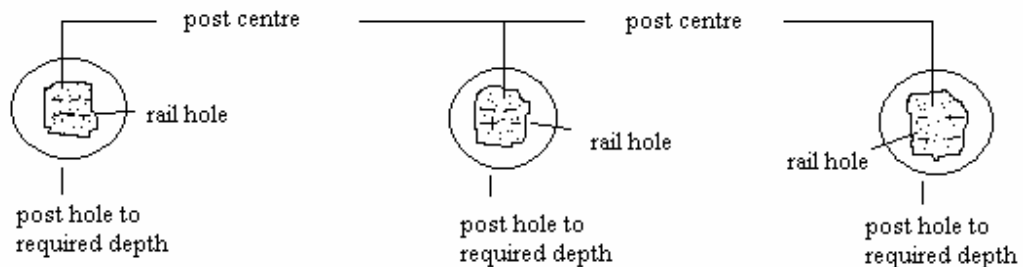

- Step .2. Dig all the post holes to the following depths
- | | |
|--------|--------------|
| FP1800 | 600 mm deep |
| FP1300 | 455 mm deep |
| FP900 | 455 mm deep |
| GP2400 | 1200 mm deep |

- Step .3. Place the post in the hole, ensuring the rail holes are parallel to the direction of the fence, and dry ram the soil back around the post. Some directional change can be achieved along the fence line with the space in the rail holes, but in twisting the rails in the hole there is a risk of breaking the end of the rails.

Hint:- Unlike a conventional fence, it is not necessary to have every post perfectly inline and vertical. Being a little crooked with a post leaning slightly does add to the rustic charm of the finished fence.

Step .4. Place the thin end of the rail into the selected rail hole and slide all the way into the rail hole until the other end of the rail clears the inside of the second post.



Now slide the rail back into the rail hole in the second post and even the rail up between the posts.

Hint:- Start with the bottom rails otherwise you will bang your head on the ones above.

Step .5. The procedure for the next panel rails is exactly the same, except the previously placed rail may need to be held across to one side of the rail hole until the next rail is located

Hint:- If it is required to lock the rails in place to prevent theft etc. in public areas. Secure the rails in the post holes using Selleys Landscape Liquid Nails. It's grey and blends in nicely while staying flexible to allow for expansion and contraction.

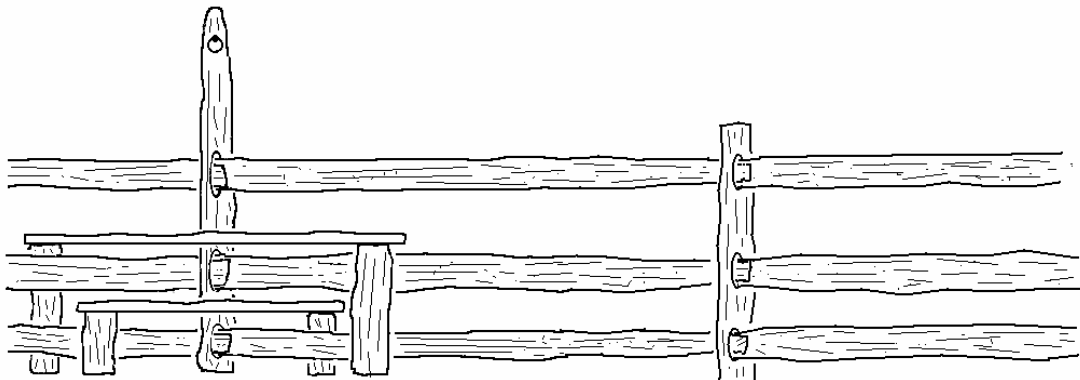

Mulga Fence with stile

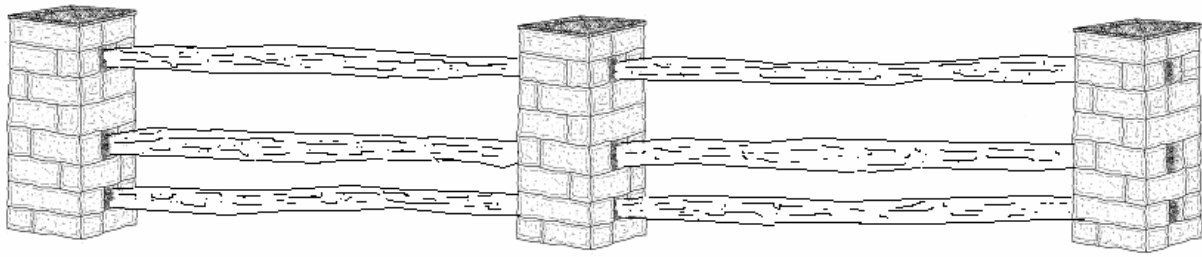

Gawler™ Stack Pillars with Mulga fence rails

When using ***Gawler™ Stack Stone Pillars*** instead of posts for the ***Mulga Fence*** the installation of the rails will be the same but you will need to follow the guidelines below for the pillar installation.

Step .1. PREPARE THE FOUNDATION

Measure and mark out the location of the Pillar. Excavate the base hole approximately 500mm x 500mm wide and approximately 300mm deep for a fence pillar or 500mm deep for a gate post. Board up any sections of hole if necessary to screed a level top. Mix and pour the concrete into the hole, and while the concrete is green, push in some short lengths of reo bar at the centre of the concrete base as starter bars.

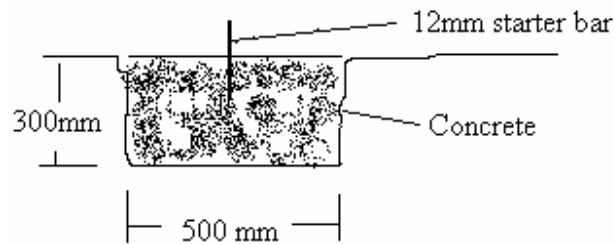

A typical fence pillar foundation

Step .2. BASE COURSE INSTALLATION

This is the most important course of the pillar as the rest of the pillar relies upon it. Accuracy is critical for a well constructed good looking pillar. Spread a thin layer of mortar or tile adhesive across the foundation (thick enough to level off from the foundation variations). Place the first course of ***Gawler™ Stack Stone Pillar*** block on the prepared base, tapping it down with a rubber mallet to ensure a good bedding. Ensure the block is level, end to end, back to front. Use a string line for alignment of the other pillars.

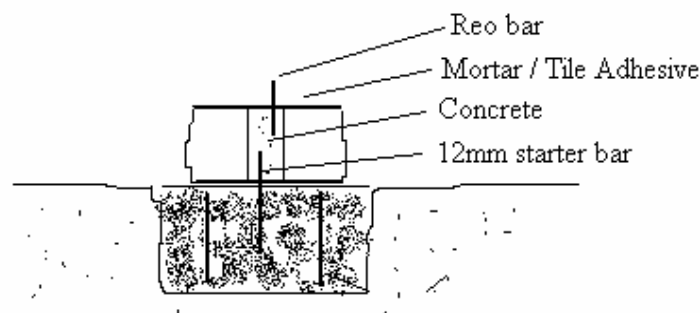

Step .3.

ADDITIONAL COURSES

Fill the block cavity from the previous course, with concrete. If desired spread a thin layer of mortar mix or tile adhesive on the top of the previous blocks, (note:- this is not essential though) . Place the next course of **Gawler™ Stack Stone Pillar** block on top of the first, ensure the blocks butt together and for aesthetics, the stone joints should not run in line. Insert reo bars into the block cavity and push them down into the concrete filled cavity of the previous block, ensuring half of the rod length is inserted. Continue the process as you work up the pillar.

Note:- When using the **Mulga** fence rails with the **Stack Pillar**, after the first layer has been filled with concrete the succeeding layers may be glued together with Selleys Landscape Liquid Nails. **DO NOT** do this for a gate pillar.

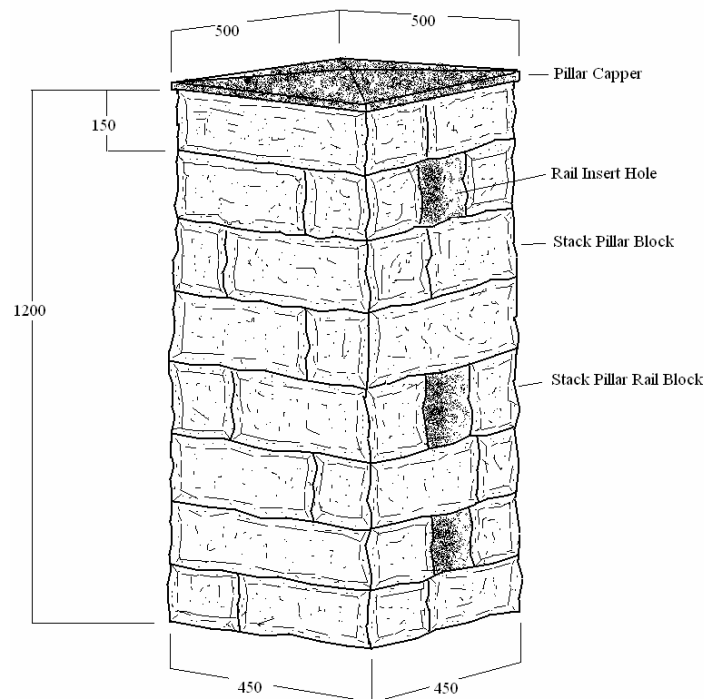

**Gawler™ Stack Pillar
for Mulga fence rails**

Step .4.

Install the rails as per Step .4. above