

Mulga Products® (Australia)



Mulga Estate Post 'N' Rail™ Fence

Installation Guide

- Step .1. Set out and mark the location of the posts holes at the following spacing, dependent upon the rail size
- | | |
|--------------|----------------------|
| EFR2700 rail | (post 2.75m centres) |
| EFR2500 rail | (post 2.55m centres) |
| EFR2300 rail | (post 2.35m centres) |
| EFR2100 rail | (post 2.15m centres) |
| EFR1900 rail | (post 1.95m centres) |
| EFR1700 rail | (post 1.75m centres) |
| EFR1500 rail | (post 1.55m centres) |
| EFR1050 rail | (post 1.05m centre) |

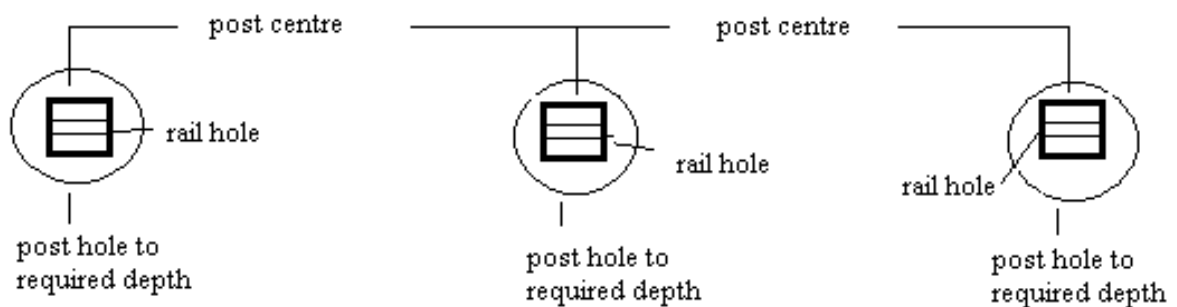

- Step .2. Dig all the post holes to the following depths
- | | |
|---------|--------------|
| EFP1800 | 600 mm deep |
| EFP1300 | 455 mm deep |
| EFP900 | 455 mm deep |
| EGP2400 | 1200 mm deep |

- Step .3. Place the first post in the hole, ensuring the rail holes are parallel to the direction of the fence, and dry ram the soil back around the post.
Some directional change can be achieved along the fence line with the

space in the rail holes, but in twisting the rails in the hole there is a risk of breaking the end of the rails.

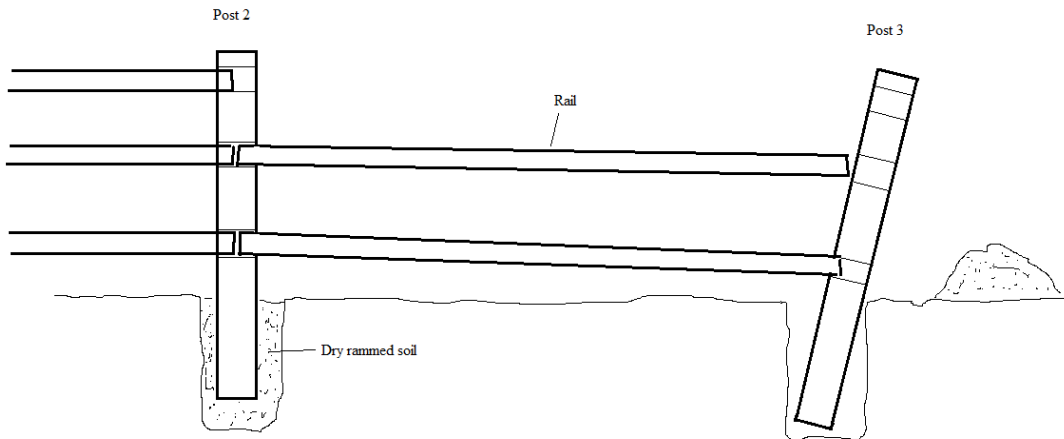

Step .4. Place the second post in the hole and lean away from the first post

Hint:- You will need a couple of people to help hold, place rails and stand up posts.

Step .5. Place one end of the rail into the bottom rail hole and slide half way into the rail hole, align with the bottom hole in the second post and stand second post partly upright, inserting the bottom rail just into the bottom hole.

Step .6. Place one end of the middle rail into the middle rail hole and slide half way into the rail hole, align with the middle hole in the second post and stand second post a little more upright, inserting the middle rail into the middle hole. This will mean the bottom rail will be slide a little deeper into the bottom hole.

Step .7. Repeat the above process for the top rail. The second post will completely upright and can be dry rammed into place. Ensure the rails are in the centre of the post holes to allow the end of the next rail to be placed correctly.

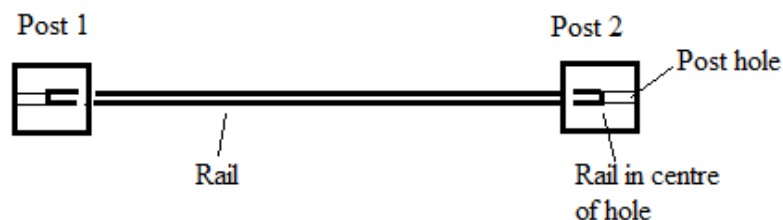

Step .8. Continue the procedure for the next panel of rails.

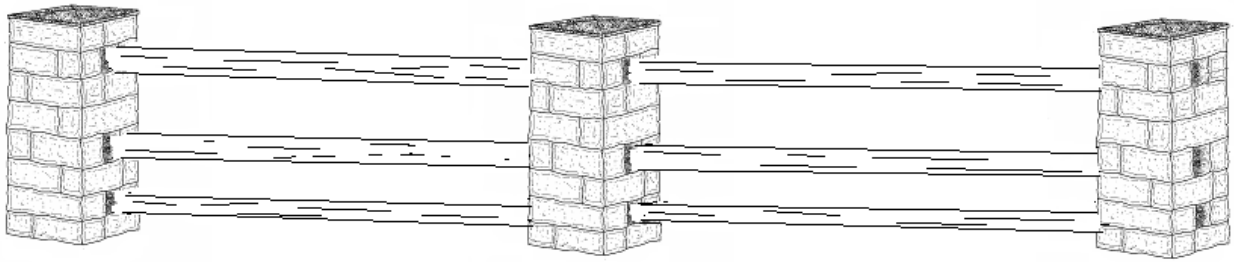

Gawler Stack Stone Pillars™ with Mulga Estate fence rails

When using ***Gawler™ Stack Stone Pillars*** instead of posts for the ***Mulga Fence*** the installation of the rails will be the same but you will need to follow the guidelines below for the pillar installation.

Step .1. PREPARE THE FOUNDATION

Measure and mark out the location of the Pillar. Excavate the base hole approximately 500mm x 500mm wide and approximately 300mm deep for a fence pillar or 500mm deep for a gate post. Board up any sections of hole if necessary to screed a level top. Mix and pour the concrete into the hole, and while the concrete is green, push in some short lengths of reo bar at the centre of the concrete base as starter bars.

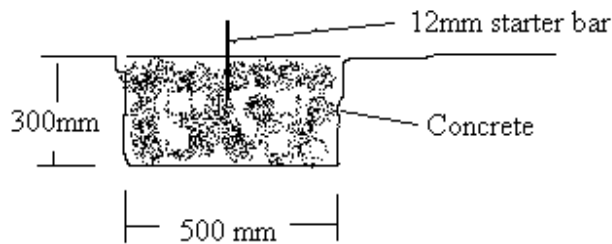

A typical fence pillar foundation

Step .2. BASE COURSE INSTALLATION

This is the most important course of the pillar as the rest of the pillar relies upon it. Accuracy is critical for a well constructed good looking pillar. Spread a thin layer of mortar or tile adhesive across the foundation (thick enough to level off from the foundation variations). Place the first course of ***Gawler Stack Stone Pillar™*** block on the prepared base, tapping it down with a rubber mallet to ensure a good bedding. Ensure the block is level, end to end, back to front. Use a string line for alignment of the other pillars.

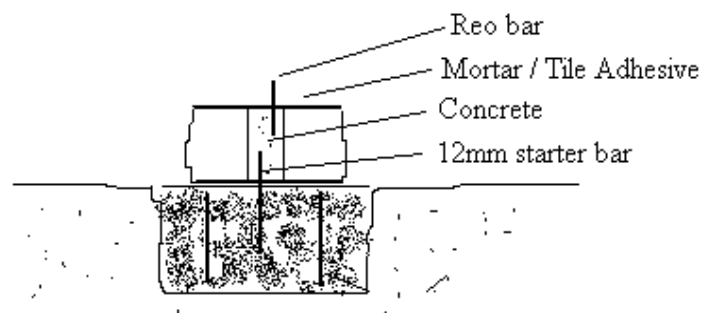

Step .3.

ADDITIONAL COURSES

Fill the block cavity from the previous course, with concrete. If desired spread a thin layer of mortar mix or tile adhesive on the top of the previous blocks, (note:- this is not essential though) . Place the next course of **Gawler Stack Stone Pillar™** block on top of the first, ensure the blocks butt together and for aesthetics, the stone joints should not run in line. Insert reo bars into the block cavity and push them down into the concrete filled cavity of the previous block, ensuring half of the rod length is inserted. Continue the process as you work up the pillar.

Note:- When using the **Mulga Estate** fence rails with the **Stack Pillar**, after the first layer has been filled with concrete the succeeding layers may be glued together with Selleys Landscape Liquid Nails. DO NOT do this for a gate pillar.

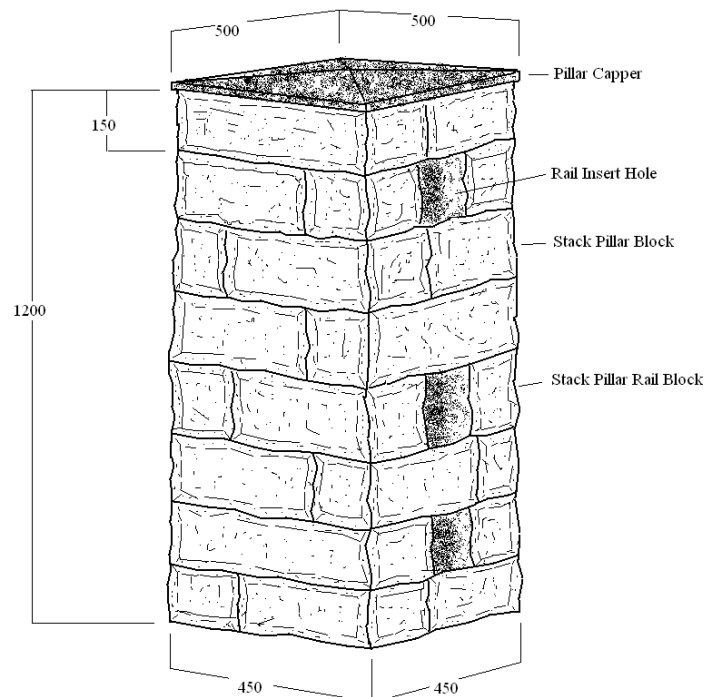

Gawler Stack Stone Pillar™
for Mulga Estate fence rails

Step .4.

Install the rails as the pillar is constructed.